

Part Names – Main Unit

Front view

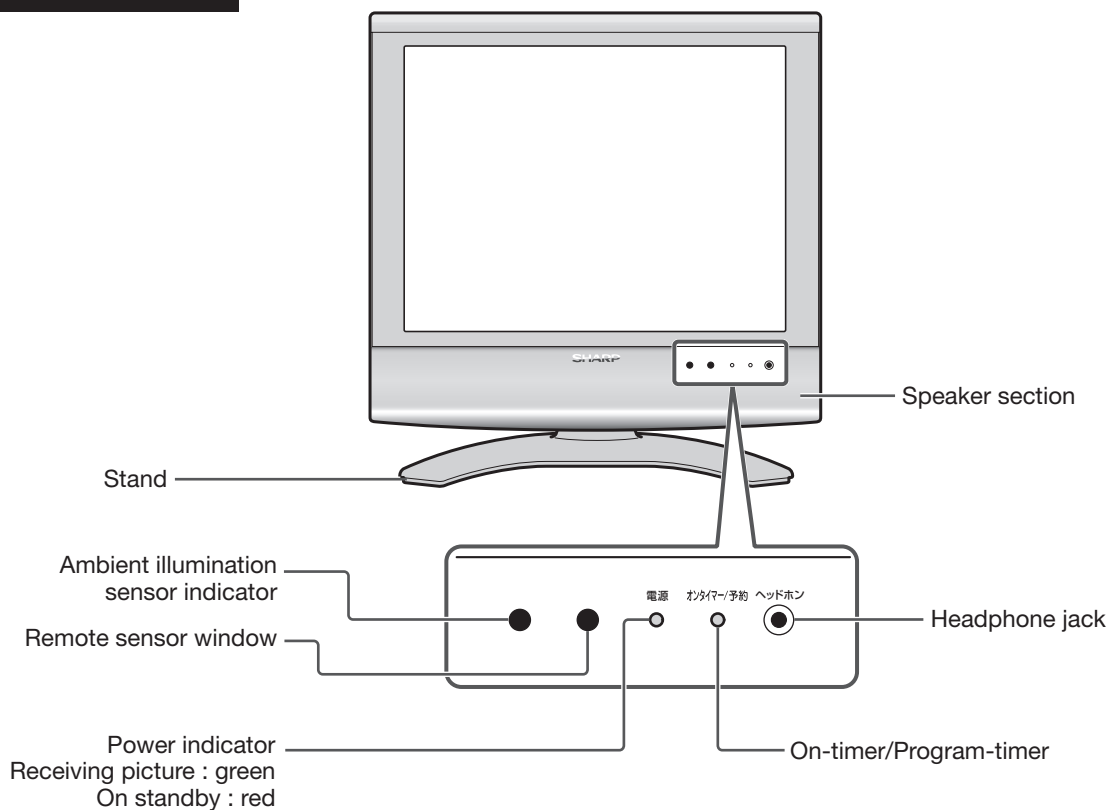

Top view

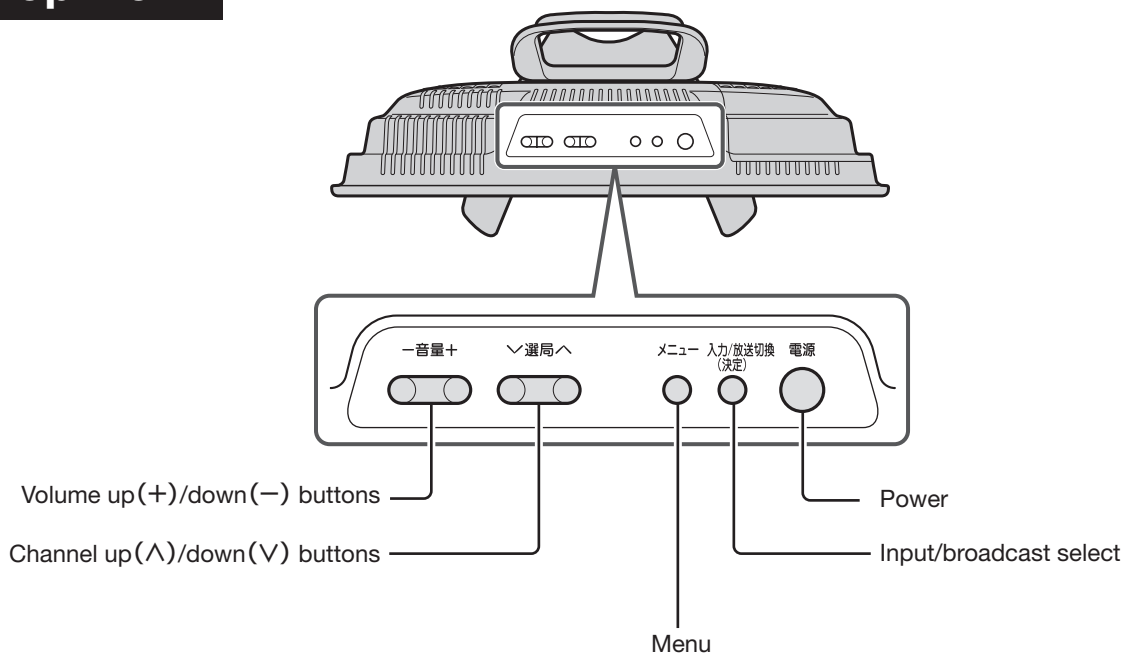

Part Names – Main Unit

Rear view

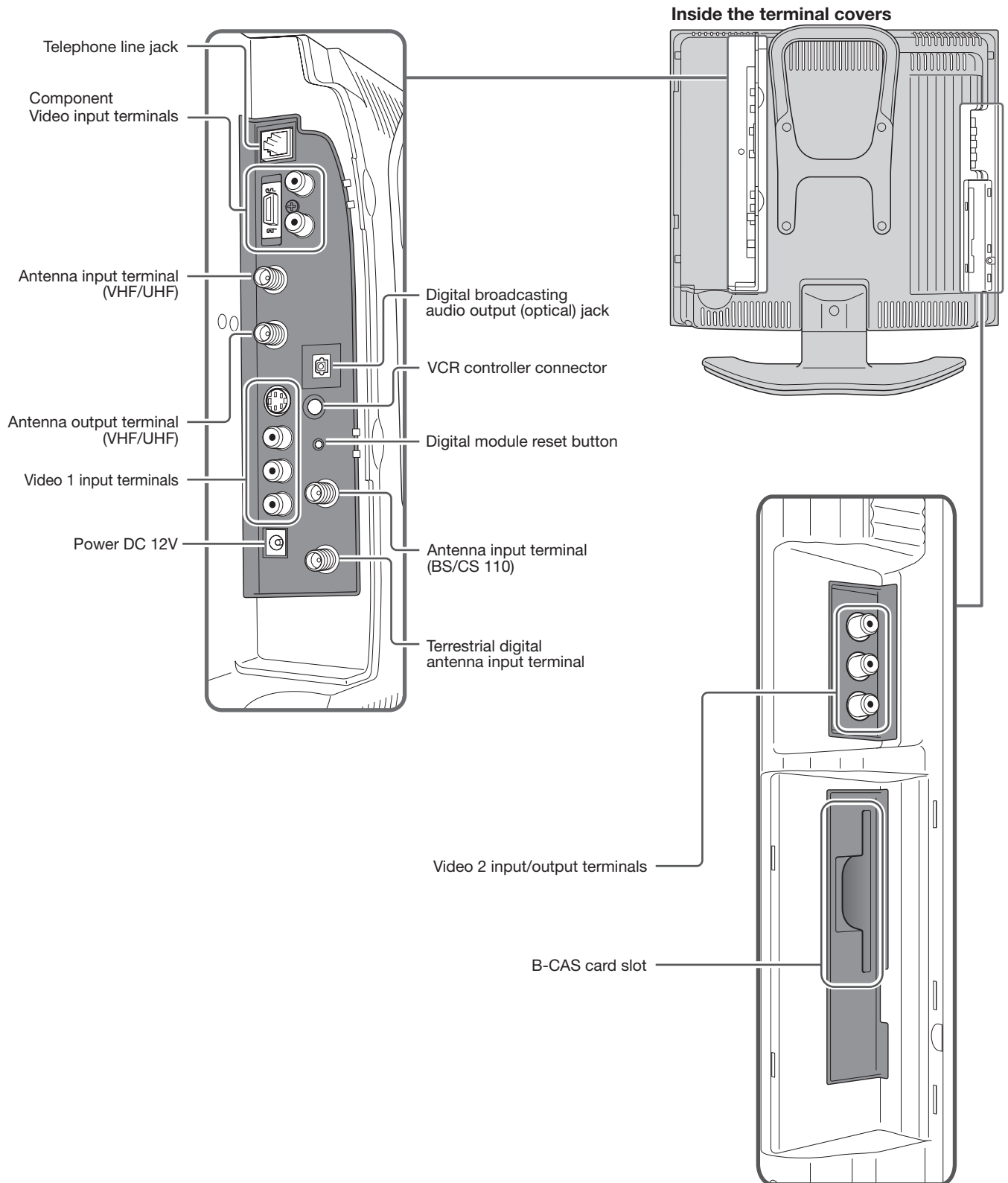

Part Names – Remote Control Unit

Cover closed

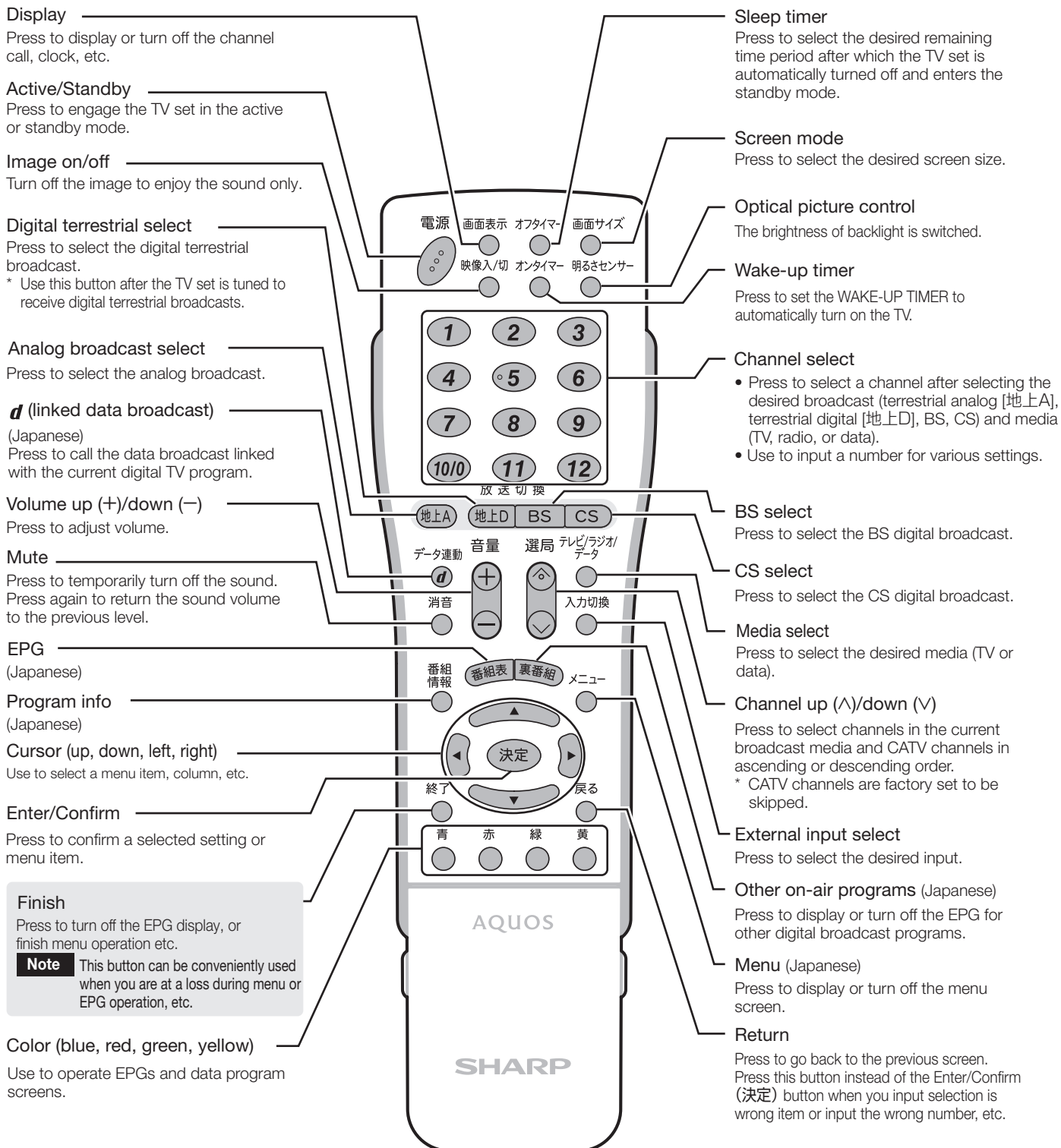

Part Names — Remote Control Unit

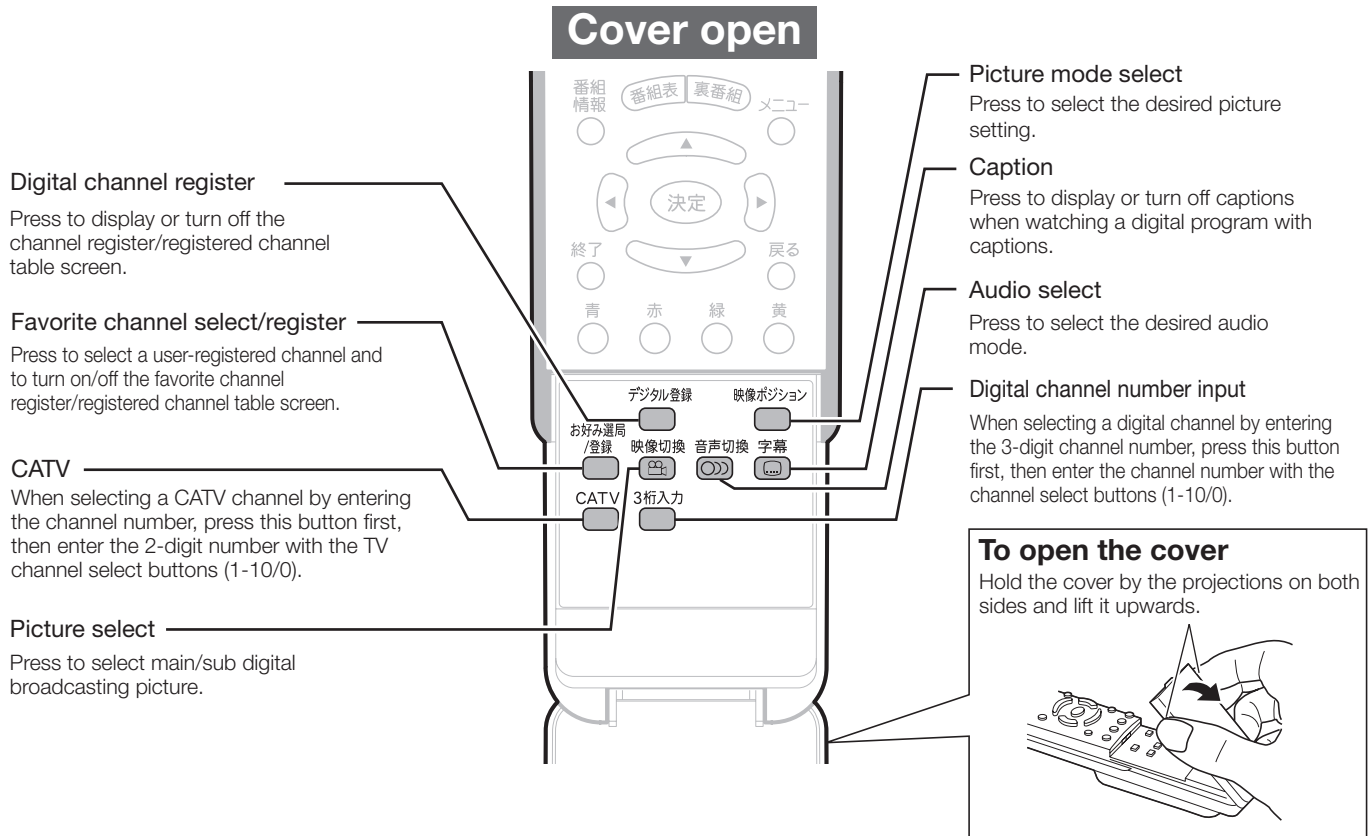

Basic operation for channel selection

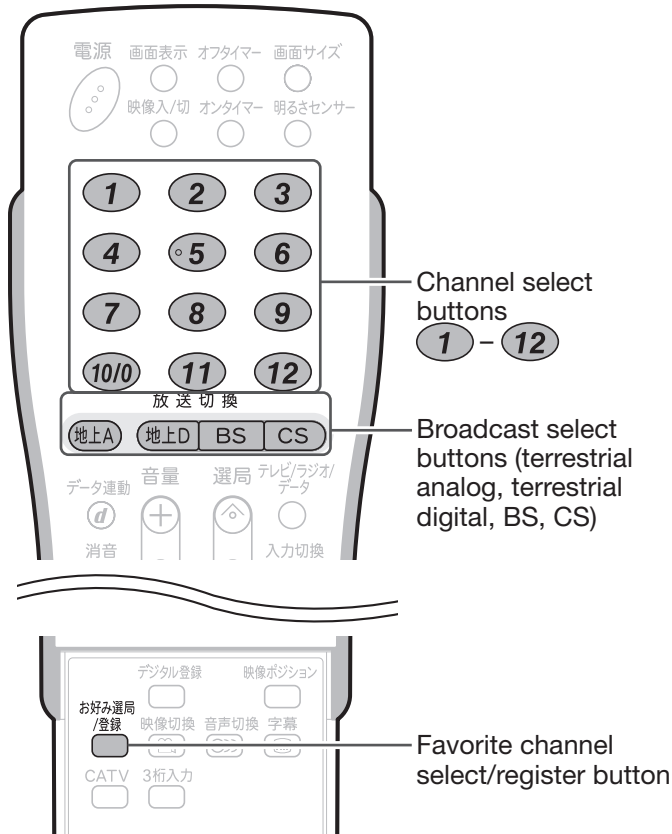

Selecting terrestrial analog (VHF/UHF) channels

- 1 Press **地上A** to select terrestrial analog broadcast.
- 2 Press **1** - **12** to select the desired channel.

Selecting digital channels

- 1 Press **地上D**, **BS** or **CS** to select the desired digital broadcast network.
- 2 Press **1** - **12** to select the desired channel.

Types of broadcast

- **地上A** Terrestrial analog: Conventional VHF/UHF broadcast
- **地上D** Terrestrial digital: Terrestrial digital broadcast
- **BS** BS: BS digital broadcast
- **CS** CS: CS 110 digital broadcast

Selecting favorite channels

- 1 Press **お好み選局/登録** to display the registered channel screen.
- 2 Press **1** - **12** to select the desired channel.