

### 3-5. Other interior features

## Sun visors



- 1 Forward position: Flip down.
- 2 Side position: Flip down, unhook, and swing to the side.

### 3-5. Other interior features

## Vanity mirror



The light turns on when the cover is opened.

## 3-5. Other interior features

# Clock



- 1 Adjusts the hour.
  - 2 Adjusts the minutes.
  - 3 Rounds to the nearest hour.\*
- \*: e.g. 1:00 to 1:29 → 1:00  
1:30 to 1:59 → 2:00

- n The clock is displayed when  
The engine switch is in ACC or IG-ON mode.

## 3-5. Other interior features

### Satellite switches

The satellite switches can be used to change the settings of various features. Settings are shown on the multi-information display.

#### n Operating the satellite switches



Bring up the satellite switch mode on the multi-information display.

Press the left selector switch, the main switch, or the right selector switch.

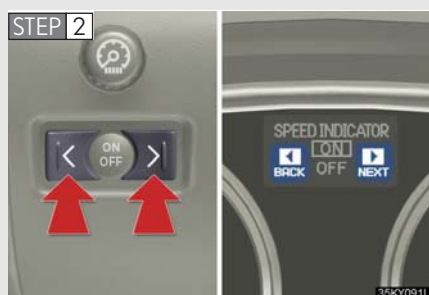

Select the item whose setting is to be changed.

Press either the left or right selector switch to display the item whose setting is to be changed.

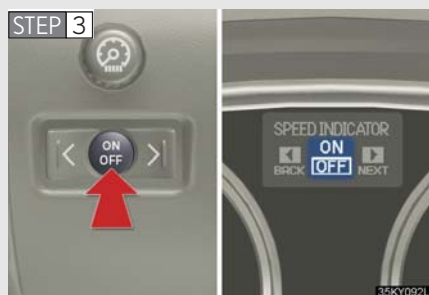

Change the settings.

Press the main switch to change the settings (e.g. ON/OFF).

## n Items that can be set using the satellite switches



Lexus parking assist-sensor (→P. 133) ON/OFF (if equipped)



Tire pressure warning system initialization (→P. 277)



ID code selection for tire air pressure system (→P. 278)



AFS (Adaptive Front-lighting System) (→P. 114) ON/OFF (if equipped)



Vehicle speed indicator ON/OFF and speed setting (→P. 102)



Tacho indicator ON/OFF and engine speed (rpm) setting (→P. 103)

### ■ **Changing the settings**

Each item is displayed and its setting can be changed only in the following conditions:

Lexus parking assist-sensor: When the engine switch is in IG-ON mode.

Items other than the above: When the engine switch is in IG-ON mode and the vehicle is stopped.

### ■ **Display**

The display will return to the original display if the satellite switches are not operated for an extended period.

Even if the display is in satellite switch mode, it will switch in the event of a warning or when the radar cruise control is used. If this occurs, press any of the satellite switches or DISP switch on the steering wheel to return the display to satellite switch mode.

## 3-5. Other interior features

### Ashtrays

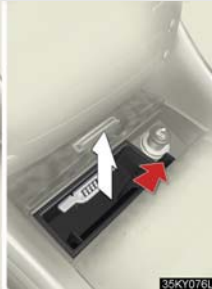

#### ► Front

Push the back part of the lid to open.

Push the lid again to close.

Push the lever to remove the ashtray.



#### ► Rear

Pull the ashtray lid to open.

Hold the plate down and pull the ashtray upwards to remove.

### ⚠ CAUTION

#### n When not in use

Keep the ashtray closed.

Injuries may result in the event of an accident or sudden braking.

### ⚠ NOTICE

#### n To prevent fire

1 Fully extinguish matches and cigarettes before putting them in the ashtray, then make sure the ashtray is closed.

1 Do not place paper or any other type of flammable object in the ashtray.

### 3-5. Other interior features

## Cigarette lighter



Push the back part of the lid to open, and push the cigarette lighter down.

The cigarette lighter will pop up when it is ready for use.

#### n The cigarette lighter can be used when

The engine switch is in ACC or IG-ON mode.

#### **!** CAUTION

#### n To avoid burns or fires

- 1 Do not touch the metal parts of the cigarette lighter.
- 1 Do not hold the cigarette lighter down. It could overheat and cause a fire.
- 1 Do not insert anything other than the cigarette lighter into the outlet.



## 3-5. Other interior features

### Power outlet

The power outlet can be used for 12 V accessories that run on less than 10 A.

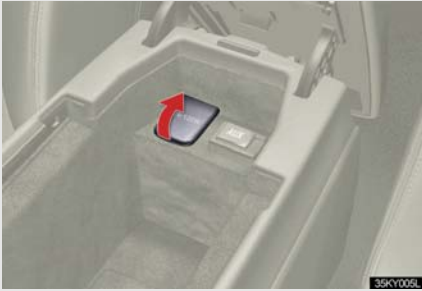

- n **The power outlet can be used when**  
The engine switch is in ACC or IG-ON mode.

#### NOTICE

- n **To avoid damaging the power outlet**  
Close the power outlet lid when the power outlet is not in use.  
Foreign objects or liquids that enter the power outlet may cause a short circuit.
- n **To prevent the fuse from being blown**  
Do not use an accessory that uses more than 12 V 10 A.
- n **To prevent the battery from being discharged**  
Do not use the power outlet longer than necessary when the engine is not running.

### 3-5. Other interior features

## Seat heaters (if equipped)

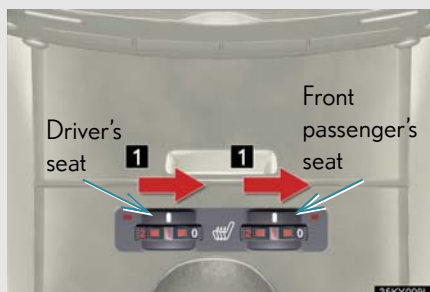

#### 1 Heats the seats

The indicator light comes on. The higher the number, the warmer the seats become.

► Vehicles with an automatic transmission

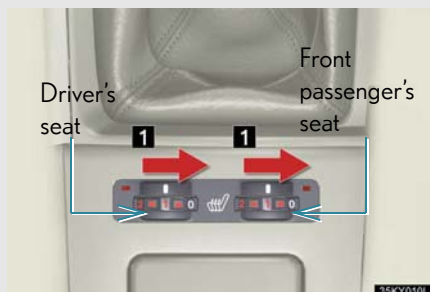

#### 1 Heats the seats

The indicator light comes on. The higher the number, the warmer the seats become.

► Vehicles with a manual transmission

#### n The seat heaters can be used when

The engine switch is in IG-ON mode.

#### n When not in use

Set the dial to 0. The indicator light turns off.

 **CAUTION****n Burns**

- I** Use caution when seating the following persons in a seat with the seat heater on to avoid the possibility of burns:
- Babies, small children, the elderly, the sick and the disabled
  - Persons with sensitive skin
  - Persons who are fatigued
  - Persons who have taken alcohol or drugs that induce sleep (sleeping drugs, cold remedies, etc.)
- I** Do not cover the seat with anything when using the seat heater. Using the seat heater with a blanket or cushion increases the temperature of the seat and may lead to overheating.

 **NOTICE****n To prevent seat heater damage**

Do not put unevenly weighted objects on the seat and do not stick sharp objects (needles, nails, etc.) into the seat.

**n To prevent battery discharge**

Turn the switches off when the engine is not running.

### 3-5. Other interior features

## Seat heaters and ventilators (if equipped)

The seat heaters and ventilators heat the seats and maintain good airflow by blowing air from the seats.

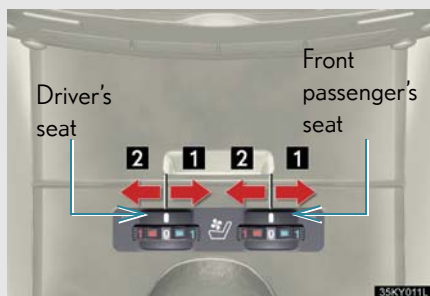

- ▶ Vehicles with an automatic transmission

#### 1 Heats the seats

The indicator light (red) comes on. The higher the number, the warmer the seats become.

#### 2 Blows air from the seats

The indicator light (green) comes on. The higher the number, the stronger the airflow becomes.

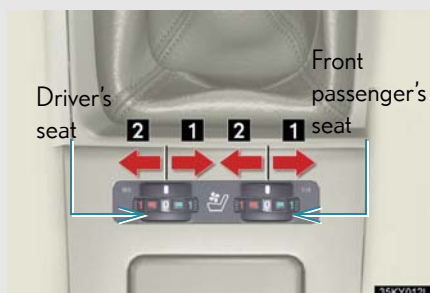

- ▶ Vehicles with a manual transmission

#### 1 Heats the seats

The indicator light (red) comes on. The higher the number, the warmer the seats become.

#### 2 Blows air from the seats

The indicator light (green) comes on. The higher the number, the stronger the airflow becomes.

#### ▮ The seat heaters and ventilators can be used when

The engine switch is in IG-ON mode.

#### ▮ When not in use

Set the dial to 0. The indicator light turns off.

 **CAUTION****n Burns**

- I** Use caution when seating the following persons in a seat with the seat heater on to avoid the possibility of burns:
- Babies, small children, the elderly, the sick and the disabled
  - Persons with sensitive skin
  - Persons who are fatigued
  - Persons who have taken alcohol or drugs that induce sleep (sleeping drugs, cold remedies, etc.)
- I** Do not cover the seat with anything when using the seat heater. Using the seat heater with a blanket or cushion increases the temperature of the seat and may lead to overheating.

 **NOTICE****n To prevent seat heater damage**

Do not put unevenly weighted objects on the seat and do not stick sharp objects (needles, nails, etc.) into the seat.

**n To prevent battery discharge**

Turn the switches off when the engine is not running.

### 3-5. Other interior features

## Armrest

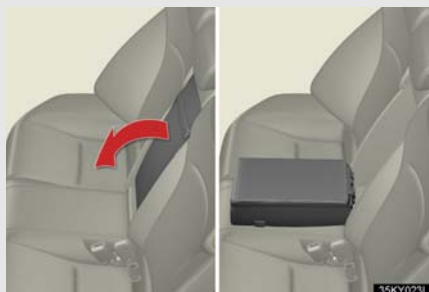

Pull the armrest down for use.

#### NOTICE

**n To prevent damage to the armrest**

Do not place too much strain on the armrest.

### 3-5. Other interior features

## Rear sunshade (if equipped)

The rear sunshade can be raised and lowered by operating the switch shown below.

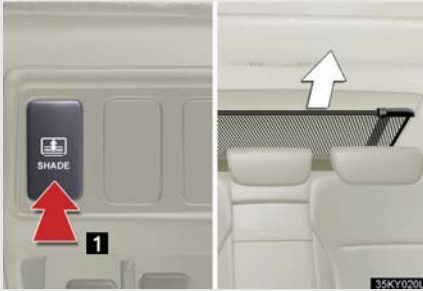

1 Raise/lower

#### n Reverse operation feature

To ensure adequate rear visibility, the sunshade automatically lowers when the gear is shifted to R.

However, the rear sunshade is raised again if either of the following occurs:

- 1 The switch is pressed again.
- 1 The shift lever is shifted out of R, and the vehicle reaches a speed of 9 mph (15 km/h).

If the engine is turned off when the rear sunshade has been lowered due to the reverse operation feature, it will not be raised even when the engine is turned on again and the vehicle reaches a speed of 9 mph (15 km/h). To raise the sunshade again, press the switch.

#### n The rear sunshade can be used when

The engine switch is in IG-ON mode.

### ! CAUTION

#### n When the rear sunshade is being raised or lowered

Do not place fingers or other objects in the fastener section or in the opening. They may get caught, causing injury.

#### NOTICE

**n To prevent the battery from being discharged**

Do not operate the rear sunshade when the engine is not running.

**n To ensure normal operation of the sunshade**

Observe the following precautions.

- l** Do not place excessive load on the motor or other components.
- l** Do not place objects where they may hinder opening and closing operations.
- l** Do not attach items to the rear sunshade.
- l** Keep the opening clean and clear of obstructions.
- l** Do not operate the rear sunshade continuously over long periods of time.



## 3-5. Other interior features

### Extended trunk

Long objects can be loaded in the vehicle by utilizing the trunk space and rear seat area.

STEP 1



Pull down the rear seat armrest.

STEP 2



Open the inside trunk door from the trunk and load baggage or other items.

#### CAUTION

##### **n** When not in use

Ensure that the inside trunk door is closed.

In the event of sudden braking, items stored in the trunk may be thrown forward into the cabin, resulting in injury.

### 3-5. Other interior features

## Coat hooks

Pull out the hooks to hang coats or other soft items.

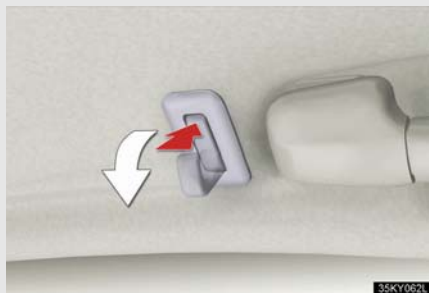

### CAUTION

#### **n** Items that must not be hung on the hook

Do not hang a coat hanger or other hard or sharp object on the hook. If the SRS curtain shield airbags deploy, these items may become projectiles that cause death or serious injury.

### 3-5. Other interior features

## Floor mat

Securely place a mat that matches the size of the space on the carpet.

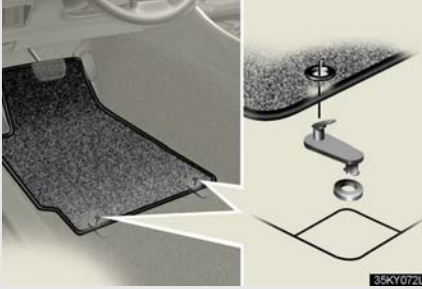

Secure the driver's floor mat using the hooks provided.

#### CAUTION

##### **n** When inserting the floor mat

Make sure the floor mat is properly placed on the floor carpet. If the floor mat slips and interferes with the movement of the pedals during driving, it may cause an accident.

### 3-5. Other interior features

## Trunk features

#### n Cargo hooks



Cargo hooks are provided for securing loose items.

#### n Shopping bag hooks



#### n First-aid kit storage belt (if equipped)



- 1 Loosen
- 2 Tighten

### n Warning triangle storage belt

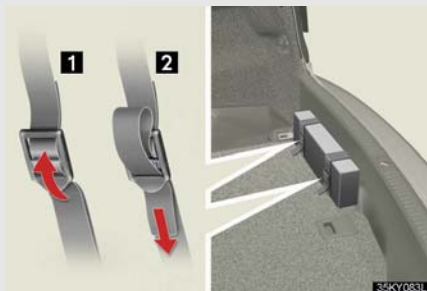

- 1 Loosen
- 2 Tighten

### n Luggage mat



Pull the lever upwards when lifting the luggage mat up.



The lever can be hooked on the edge of the trunk.

### ! CAUTION

#### n When the cargo hooks are not in use

To avoid injury, always return the cargo hooks to their positions when they are not in use.

 NOTICE

**n When closing the trunk**

Do not leave the luggage mat lever hooked on the edge of the trunk.  
The luggage mat may get damaged.

### 3-5. Other interior features

## Garage door opener

The garage door opener can be programmed to operate garage doors, gates, entry doors, door locks, home lighting systems, and security systems, and other devices.

The garage door opener (HomeLink® Universal Transceiver) is manufactured under license from HomeLink®.

### Programming the HomeLink® (for U.S.A. owners)

The HomeLink® compatible transceiver in your vehicle has 3 buttons which can be programmed to operate 3 different devices. Refer to the programming method below appropriate for the device.

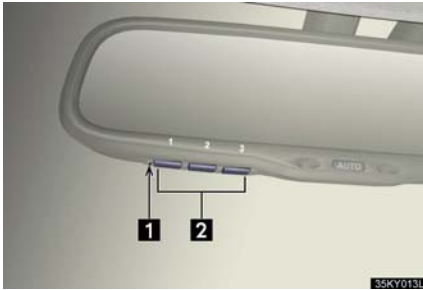

- 1** Indicator
- 2** Buttons

#### n Programming the HomeLink®

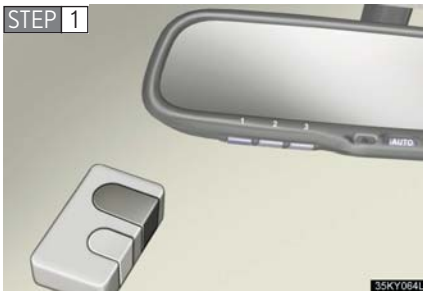

Point the remote control for the device 1 to 3 in. (25 to 75 mm) from the HomeLink® control buttons.

Keep the indicator light on the HomeLink® in view while programming.

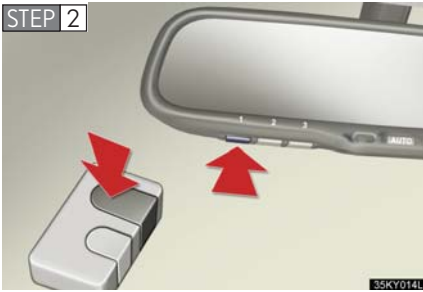

Press and hold down one of the buttons on the HomeLink<sup>®</sup> and the button on the transmitter. When the indicator light on the HomeLink<sup>®</sup> changes from a slow to a rapid flash after 20 seconds, you can release both buttons.

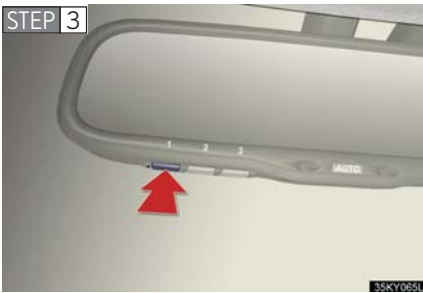

Test the operation of the HomeLink<sup>®</sup> by pressing the newly programmed button.

If programming a garage door opener, check to see if the garage door opens and closes. If the garage door does not operate, see if your garage transmitter is of the Rolling Code type. Press and hold the programmed HomeLink<sup>®</sup> button. The garage door has the rolling code feature if the indicator light (on the HomeLink<sup>®</sup>) flashes rapidly for 2 seconds and then remains lit. If your transmitter is the Rolling Code type, proceed to the heading "Programming a rolling code system".

**STEP 4** Repeat the steps above to program another device for each of the remaining HomeLink<sup>®</sup> buttons.



### n Programming a Rolling Code system (for U.S.A. owners)

If your device is Rolling Code equipped, follow the steps under the heading “Programming the HomeLink®” before proceeding with the steps listed below.

**STEP 1** Locate the training button on the ceiling mounted garage door opener motor. The exact location and color of the button may vary by brand of garage door opener.

Refer to the operation manual supplied with the garage door opener for the location of the training button.

**STEP 2** Press the training button.

**STEP 3** Press and release the vehicle’s programmed HomeLink® button twice. The garage door may open.

If the garage door opens, the programming process is complete. If the door does not open, press and release the button a third time. This third press and release will complete the programming process by opening the garage door.

The ceiling mounted garage door opener motor should now recognize the HomeLink® transceiver and operate the garage door.

**STEP 4** Repeat the steps above to program another rolling code system for any of the remaining HomeLink® buttons.

### n Programming an entry gate (for U.S.A. owners)/Programming all devices in the Canadian market

**STEP 1** Place your transmitter 1 to 3 in. (25 to 75 mm) away from the surface of the HomeLink®.

Keep the indicator light on the HomeLink® in view while programming.

**STEP 2** Press and hold the selected HomeLink® button.

**STEP 3** Repeatedly press and release (cycle) the device’s remote control button for two seconds each until step 4 is complete.

**STEP 4** When the indicator light on the HomeLink® compatible transceiver start to flashing rapidly, release the buttons.

**STEP 5** Test the operation of the HomeLink<sup>®</sup> by pressing the newly programmed button. Check to see if the gate/device operates correctly.

**STEP 6** Repeat the steps above to program another device for each of the remaining HomeLink<sup>®</sup> buttons.

**n Programming other devices**

To program other devices such as home security systems, home door locks or lighting, contact your authorized Lexus dealer for assistance.

**n Reprogramming a button**

The individual HomeLink<sup>®</sup> buttons cannot be erased but can be reprogrammed. To reprogram a button, follow the “Basic programming” instructions.

**Operating the HomeLink<sup>®</sup>**

Press the appropriate HomeLink<sup>®</sup> button. The HomeLink<sup>®</sup> indicator light on the HomeLink<sup>®</sup> transceiver should turn on.

The HomeLink<sup>®</sup> continues to send a signal for up to 20 seconds as long as the button is pressed.

**Erasing the entire HomeLink<sup>®</sup> memory (all three programs)**

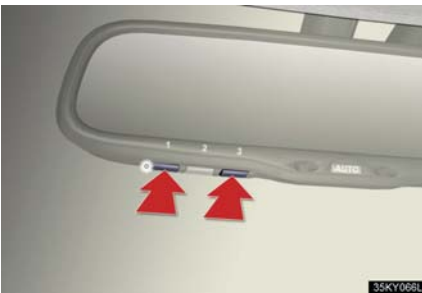

Press and hold down the 2 outside buttons for 20 seconds until the indicator light flashes.

If you sell your vehicle, be sure to erase the programs stored in the HomeLink<sup>®</sup> memory.

**n Before programming**

- 1 Install a new battery in the transmitter.
- 1 The battery side of the transmitter must be pointed away from the HomeLink®.

**n Certification for the garage door opener**

This device complies with Part 15 of the FCC Rules and with RSS-210 of the IC Rules.

Operation is subject to the following two conditions: (1) This device may not cause harmful interference, and (2) this device must accept any interference received, including interference that may cause undesired operation.

**WARNING:** This transmitter has been tested and complies with FCC and IC rules. Changes or modifications not expressly approved by the party responsible for compliance could void the user's authority to operate the device.

**⚠ CAUTION****n When programming a garage door or other remote control device**

The garage door may operate, so ensure people and objects are out of danger to prevent potential harm.

**n Conforming to federal safety standards**

Do not use the HomeLink® Compatible Transceiver with any garage door opener or device that lacks safety stop and reverse features as required by federal safety standards.

This includes any garage door that cannot detect an obstruction object. A door or device without these features increases the risk of death or serious injury.

### 3-5. Other interior features

## Compass

The compass on the inside rear view mirror indicates the direction in which the vehicle is heading.

#### n Operation

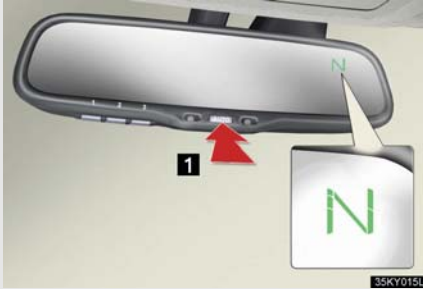

**1** To turn the compass on or off, push AUTO for longer than 3 seconds.

Push and hold the button for 3 seconds or more.

#### n Displays and directions

Display	Direction
N	North
NE	Northeast
E	East
SE	Southeast
S	South
SW	Southwest
W	West
NW	Northwest

## Calibrating the compass

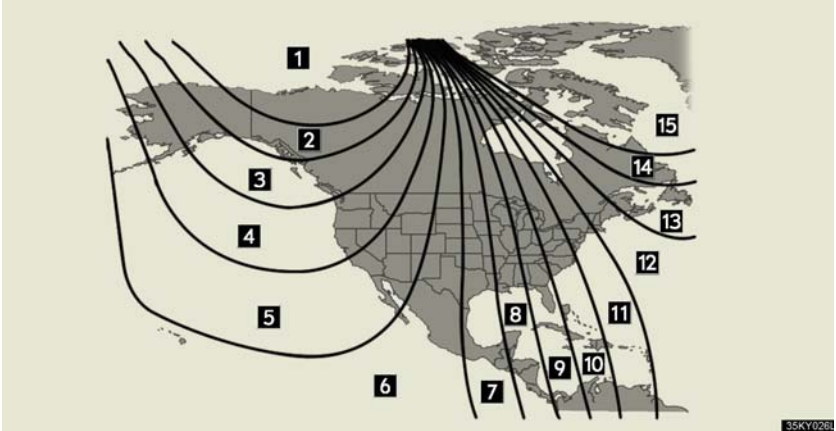

The direction display deviates from the true direction determined by the earth's magnetic field. The amount of deviation varies according to the geographic position of the vehicle.

If you cross over a map boundary shown in illustration, the compass will deviate.

To obtain higher precision or perfect calibration, refer to the following.

### n Deviation calibration

**STEP 1** Stop the vehicle where it is safe to drive in a circle.

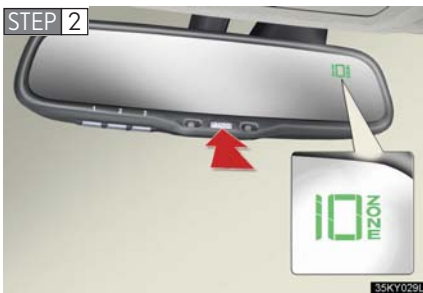

Press AUTO until a number (1 to 15) appears on the compass display.

**STEP 3** Press AUTO, and referring to the map above, select the number of the zone where you are.

**STEP 4** Press AUTO again.

If the direction is displayed several seconds after adjustment, the calibration is complete.

### n Circling calibration

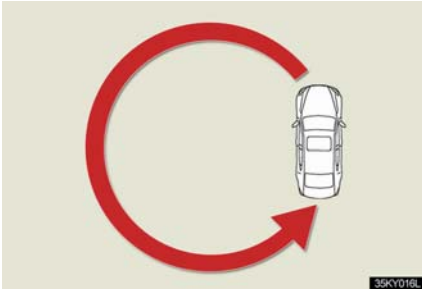

If CAL appears on the display, drive the vehicle at 5 mph (8 km/h) or less in a circle until a direction is displayed.

If there is not enough space to drive in a circle, drive around the block until the direction is displayed.

---

### n Conditions unfavorable to correct operation

The compass may not show the correct direction in the following conditions:

- 1 The vehicle is stopped immediately after turning.
- 1 The vehicle is on an inclined surface.
- 1 The vehicle is in a place where the earth's magnetic field is subject to interference by artificial magnetic fields (underground car park/parking lot, under a steel tower, between buildings, roof car park/parking lot, near an intersection, near a large vehicle, etc.).
- 1 The vehicle has become magnetized.  
(There is a magnet or metal object near the inside rear view mirror.)
- 1 The battery has been disconnected.
- 1 A door is open.

 **CAUTION****n While driving the vehicle**

Do not adjust the display. Be sure to adjust the display only when the vehicle is stopped.

**n When doing the circling calibration**

Be sure to secure a wide space, and watch out for people and vehicles in the neighborhood. Do not violate any local traffic rules while performing circling calibration.

 **NOTICE****n To avoid the compass malfunctions**

Do not place magnets or any metal objects near the inside rear view mirror. Doing this may cause a malfunction of the compass sensor.

**n To ensure normal operation of the compass**

- l** Do not perform circling calibration of the compass in a place where the earth's magnetic field is subject to interference by artificial magnetic fields.
- l** During calibration, do not operate electric systems (moon roof, power windows, etc.) as they may interfere with the calibration.

